

**SAY HELLO TO YOUR LITTLE DISCO FWEND**  
Use sufficient work light. If not too much of a hassle, move the turntable so you can easily access all angles.

#### MOUNTING INSTRUCTIONS

Read **through** the manual **before** you begin mounting.

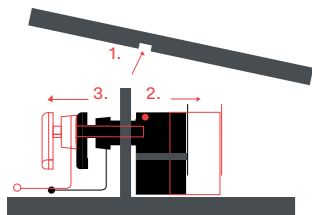

fig. 1

#### UNPACKING

Pull the loose wall away from the “H” and place the frame on a flat surface. Loosen the set screw slightly and pull out the base (see fig. 1).

Gently pull the top part out from the base side, without handling the release-antenna, and lay it on a flat surface with the antenna facing up. Leave the top part for later.

Think of the release-antenna as the cantilever of a cartridge - handle the mechanical parts with care.

The fine-tuned mechanics inside might not function properly if the release-antenna is bent out of shape.

#### INSTALL BASE

The turntable motor should be powered off until mounting is complete.

The base has a pre-installed double-sided tape. Extra tape for emergencies is included. Line up the base according to figure 2, it is not super critical that it lines up 100%. If you are unsure about positioning, do a rehearsal run before you remove the protective layer from the double-sided tape.

Slightly push the base against the knurled VTA ring, lower it and adhere while the front tip stays inside the outer circumference (see fig. 2).

fig. 2

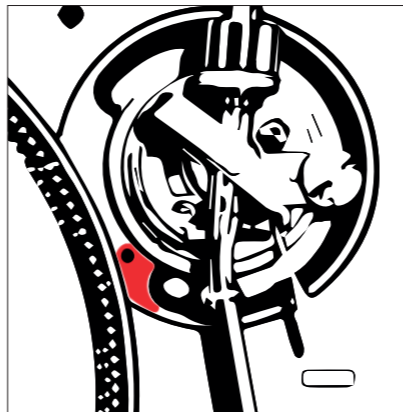

#### SET RELEASE-ANTENNA ANGLE & HEIGHT

The relation of the rubber beam to the steel wire sticking out should be approx. 90 degrees (if not, hold the top part securely and rotate the rubber beam clockwise).

Leave the tonearm in its resting position. Put a 12” vinyl record on the platter. Lower the top part all the way down into the black base.

Rotate the top so the release-antenna points towards the platter spindle. Insert the long end of the enclosed hex key into the set screw in the base and tighten gently, then untighten 1/8 of a rotation. Leave the key inserted until adjustments are completed.

Gently push the rubber beam down to its loaded position (see fig. 3).

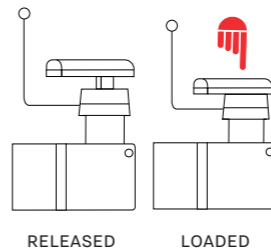

fig. 3

Swing the tonearm in towards the run-out area and lower the stylus tip approx. 15mm out from the edge of the records paper label (see fig. 4).

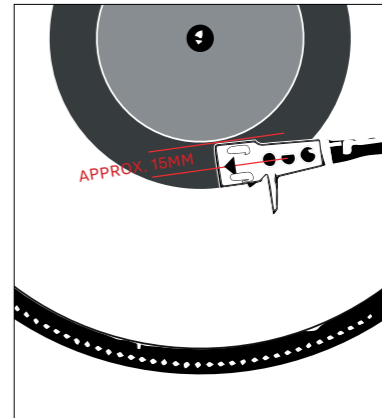

fig. 4

If the tonearm has a standard, parallel set VTA (Vertical Tracking Angle) - you should now have clearance between the rubber beam and tonearm.

If not, raise the VTA or put a mat on the platter.

Rotate the top counter-clockwise until the release-antenna almost touches the tonearm. You should now have the correct angle for release (see fig. 5).

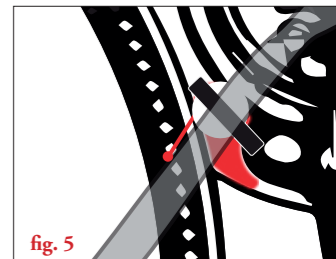
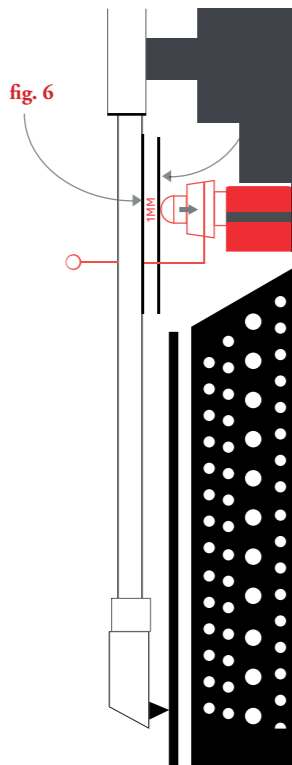

fig. 5

The next step is somewhat fiddly due to the tight space, but just take it slow and make sure you don't accidentally move the tonearm while the stylus is in the groove. Check that the rubber beam is loaded.

Raise the top part to achieve approx. 1mm clearance between tonearm and rubber beam (see fig. 6) - while keeping the release-antennas angle correct. Gently tighten the set screw.



It is less nerve-racking doing the last step while the tonearm is secured in its resting position, but you will have to make a mental note of the release-antennas angle and there will probably be a bit of trial & error to get the height right.

The angle of the release-antenna can be fine-tuned if you have a record with a very narrow run-out area, but the standard angle will work for most 12" records.

Remove the hex key and store it in the plastic bag where it can be found for later re-adjustments. It is only 0.9mm and hard to find in regular hardware stores (or in black mohair rugs).

Keep the transport "H" frame in case of future moves.

REMEMBER TO LOAD YOUR  
LITTLE DISCO FWEND  
BEFORE PLAYING THE NEXT RECORD

#### DISCLAIMER

The user agrees that she/they/he is responsible for all damages and injuries caused by the use of this product, which include equipment and property damages, personal injuries, and any other damage whatsoever.

Little Fwend neither assumes nor accepts any liability for damages resulting from the handling or use of this device.

The device uses Neodymium magnets. These magnets can cause damage or injury if misused or the user have a medical condition that may be affected by magnetic fields.

Keep away from children.

The user must agree with these terms before handling the product.

#### NOTE

Please do not disassemble Little Fwend at home. If you have any technical issues please contact us.



LITTLEFWEND.COM

LITTLE FWEND™

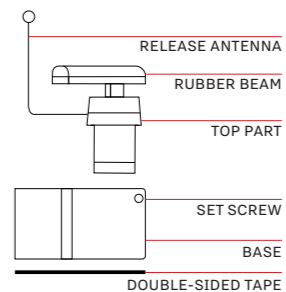

MADE IN SCANDINAVIA

LITTLE FWEND

THE AUTOMATIC TONEARM LIFTER